

**FRONT YARD**

- Means the yard between the front lotline and the nearest wall of the building

**REAR YARD**

- For the purpose of this By-law, means the remainder of the lot

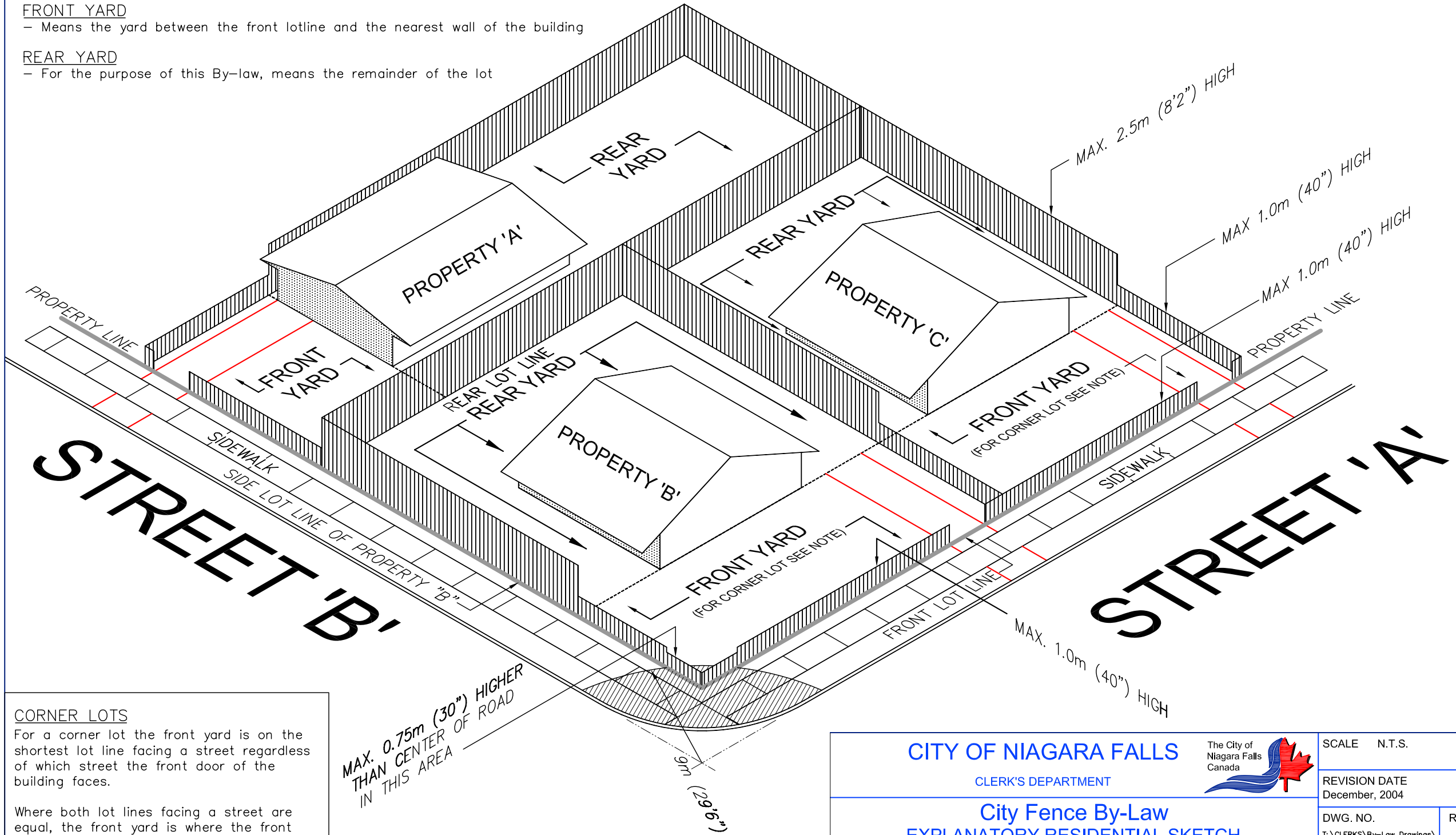

**CORNER LOTS**

For a corner lot the front yard is on the shortest lot line facing a street regardless of which street the front door of the building faces.

Where both lot lines facing a street are equal, the front yard is where the front door of the building faces.

MAX. 0.75m (30") HIGHER THAN CENTER OF ROAD IN THIS AREA

9m (29'6")

**CITY OF NIAGARA FALLS**

CLERK'S DEPARTMENT



SCALE N.T.S.

REVISION DATE  
December, 2004

**City Fence By-Law**  
**EXPLANATORY RESIDENTIAL SKETCH**  
(NOTE: SKETCH APPLIES TO NEW RESIDENTIAL FENCES ONLY)

DWG. NO.  
T:\CLERKS\By-Law Drawings\  
fence detail.dwg

REV.  
**1**